

ROOF LANTERN  
STOCK SIZE  
'CRUCIAL  
MEASUREMENT'

Roof Lantern sizes shown  
are external sizes and are  
measured to here

FULLY WEATHERED  
UPSTAND **MUST NOT**  
EXCEED THIS  
MEASUREMENT!

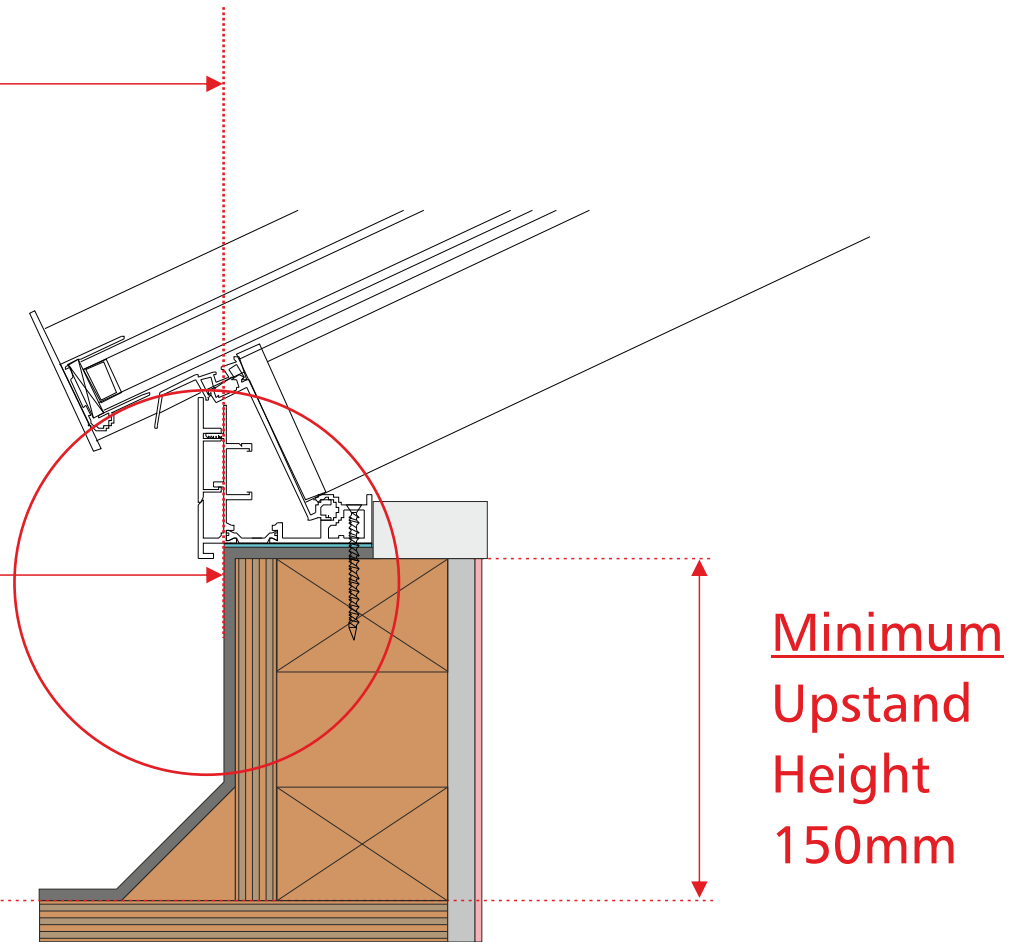

Please Note:

Your fully weathered upstand should be at least 10mm smaller on each proportion than the size of roof lantern ordered, this is to allow for a fitting tolerance.